

Quick Guide

Gauges for coating thickness measurement

DELTASCOPE® DMP10

ISOSCOPE® DMP10

DUALSCOPE® DMP20

DELTASCOPE® DMP30

ISOSCOPE® DMP30

DUALSCOPE® DMP40

SR-SCOPE® DMP30



Gauges for coating thickness measurement

DELTASCOPE® DMP10 (1007328)	DELTASCOPE® DMP30 (1007331)
ISOSCOPE® DMP10 (1007329)	ISOSCOPE® DMP30 (1007332)
DUALSCOPE® DMP20 (1007330)	DUALSCOPE® DMP40 (1007333)
	SR-SCOPE® DMP30 (1007335)

Document Number: 1009529

Edition: 07-2023 (from Firmware version 1.0.0)

Manufacturer

Helmut Fischer GmbH	Phone: +49 (0) 70 31 3 03 - 0
Institut für Elektronik und Messtechnik	Fax: +49 (0) 70 31 3 03 - 710
Industriestraße 21	www.helmut-fischer.com
D-71069 Sindelfingen	mail@helmut-fischer.com

On our home page www.helmut-fischer.com you will find the addresses of our sole agencies and subsidiary companies around the globe.

Quality Assurance System of the Helmut Fischer GmbH Institut für Elektronik und Messtechnik

DIN EN ISO/IEC 17025 Calibration lab accredited for certified mass per unit area standards

DIN EN ISO 9001:2015 Management system certified by Swiss Association for Quality and Management Systems (SQS)

© 2023 by Helmut Fischer GmbH Institut für Elektronik und Messtechnik, Germany.

This document is protected by copyright. All rights reserved. This document may not be reproduced by any means (print, photocopy, microfilm or any other method) in full or in part, or processed, multiplied or distributed to third parties by electronic means without the written consent of Helmut Fischer GmbH Institut für Elektronik und Messtechnik.

Subject to correction and technical changes.

DELTASCOPE®, ISOSCOPE®, DUALSCOPE®, SR-SCOPE® are registered trade marks of the Helmut Fischer GmbH Institut für Elektronik und Messtechnik in Germany and other countries.

Bluetooth® is a registered trade mark of the Bluetooth SIG, USA.

Note: Designations not marked with ® or ™ may also be protected by law.

Quick Guide

DMP gauge family

for coating thickness measurement

valid for the following gauge types

DELTASCOPE® DMP10

ISOSCOPE® DMP10

DUALSCOPE® DMP20

DELTASCOPE® DMP30

ISOSCOPE® DMP30

DUALSCOPE® DMP40

SR-SCOPE® DMP30



Observe the safety information and follow the instructions in operator's manual!



Detailed operator's manuals and the free-of-charge software program Tactile Suite for data evaluation and archiving can be downloaded from:

<https://docs.helmut-fischer.com/uum>

First Steps – Initial set up

The gauge is in factory delivery condition.

1. Insert the rechargeable battery into the gauge.
2. Charge the rechargeable battery.
3. Connect a probe to the gauge.
4. Switch on the gauge: press the key  for about 2 s
5. Follow the start routine and set the language, line frequency of local power supply (not SR-SCOPE® DMP30), date and time.





The main menu appears and the initial set up is finished.

What you can do next









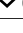

- DMP30/40 types: Define a new application (batch)
- DMP10/20 types: Define your application (batch settings)

Gauge description



- 1 Battery comp. lid, Bluetooth®
- 2 USB plug, under the lock lug of the compartment lid
- 3 Visual signal strip
- 4 Display
- 5 Operation keys
: on/off
: calls up main menu
 : selects
- 6 Plug for probe connection and battery fast charging
- 7 Gauge foot

Navigation with the gauge keys

Display	Key	Function
	 up  down	Selects – parameter/value
OK		Confirms – selection/setting Moves – cursor to the right
		Exits – page/menu Moves – cursor to the left
		Opens the Measurement view
		Opens calibration/calibration menu

Battery inserting/removing

Type RRC 1130 (3.8 V · 3.81 Ah · 14.47 Wh (supplied))

Open battery compartment

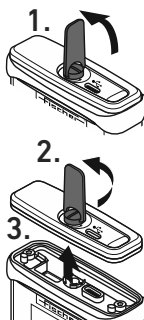

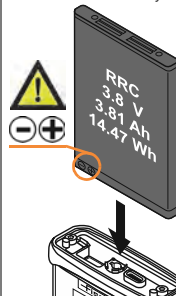

Insert battery
Observe the orientation of the battery!

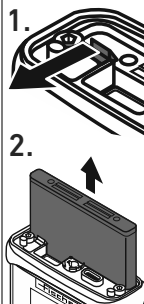

Remove battery



Charge battery

- Charge the battery before the first use.
 - USB charger: 2.4 A, 5 V $\overline{\text{---}}$; battery temp.: 0 ... 45 °C (32 ... 113 °F)
 -  = active charging,  = charging finished, Charging status enabled by switched-off gauge only
1. Connect the gauge directly to the PC via a USB cable type C/A (supplied) or to the power supply via a commercially available USB charger.
 2. Disconnect the connection when the battery is fully charged.



Connect the probe

- Connect the probe only when the gauge is switched-off!

Digital probes (D...) with USB C female jack

- Use USB C cable (supplied) to connect the gauge with the probe:

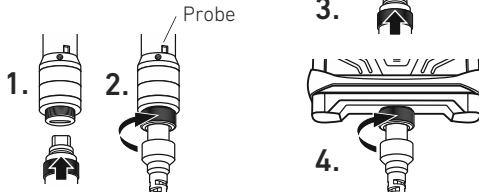

Analog probes (F...) with 12-pin male jack

- Plug in the jack of the probe cable to the DMP-F-Probe-Adapter (1007336):

Mounting DMP-F-Probe-Adapter

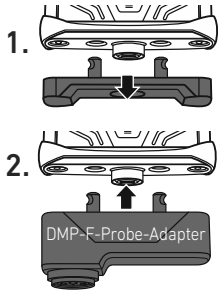

Connect the probe

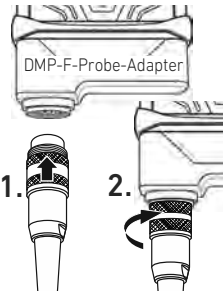

Switch gauge on/off

- Press and hold the **[ON]** key for approx. 2 s.
After switching on, the display shows the main menu or Measurement view of the batch that was open when the gauge was switched off.

Perform measurements

- For DMP30/40 types only, open the measurement view of the desired batch: **[Menu] > Batches > OK > select desired batch > OK > MEASURE > OK**
- All gauge types: Measure, place the probe vertical onto the test piece (example probe D-FN).

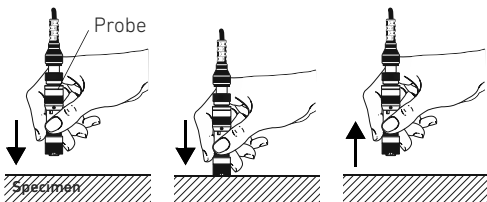

Call up evaluation

- Open the evaluation menu of the open batch: **[Menu] > Statistics > OK**

Define new application (batch)

Possible for DMP30/40 types only.

- **[Menu] > Batches > OK > New > OK > select desired calibration > OK > select desired function(s) and make desired setting(s) > MEASURE**

Define application – Batch settings

Signal of meas. acquisition (visible, audible) ☐ unit ☐
measurement mode (Single Reading, Free Run) ☐ ...

- Make the desired batch settings for the open batch:
[Menu] > Batch Modify > OK > select desired function(s) and make desired setting(s)

Define application – Calibration

- Perform a calibration: **[Menu] > Calibrations > OK > select desired calibration > OK > CALIBRATE > follow the routine and perform the displayed calibration steps**

Check calibration

- Set test parameters: **[Menu] > Calibrations > OK > select desired calibration > OK > Def. Cal. Check > OK > select/set the desired test parameters**
- Perform the check routine: **[Menu] > Calibrations > OK > select the desired calibration > OK > Check Calibration > OK > perform the test measurements according to the check routine**

Data transfer by Tactile Suite software only

Connect the gauge via USB or Bluetooth® (DMP30/40 types only) with the PC, on which the software Tactile Suite is installed.

- Call up the Tactile Suite and select your connected gauge.
The software immediately gives an overview of batches and data stored on the gauge.



How to use the Tactile Suite, please refer to the software operator's manual.

Gauge settings

Language ☐ Display settings ☐ audible and visible signals ☐ Date & Time ☐ locking selected calibrations ☐ ...

- Make the desired gauge settings: **[Menu] > Gauge Settings > OK > select the desired function(s) > OK > make the desired function setting(s)**

You can find us in:

AFRICA | ASIA | AUSTRALIA | EUROPE | NORTH AMERICA | SOUTH AMERICA



- Subsidiary

- Dealer

www.helmut-fischer.com

